



Airport City Zürich Kloten

Tri-polar development around a green heart

long-term development strategy and urban masterplan, 2008 Paris (FR)



tri-polar development

The town of Kloten is just next to the international airport of Zürich. But today they are complete different and separate 2 worlds. For the two worlds, city and airport, and for their common planning project area in Kloten, we establish a goal: a fruitful coexistence. If

Airport City Zürich Kloten Tri-polar development around a green heart

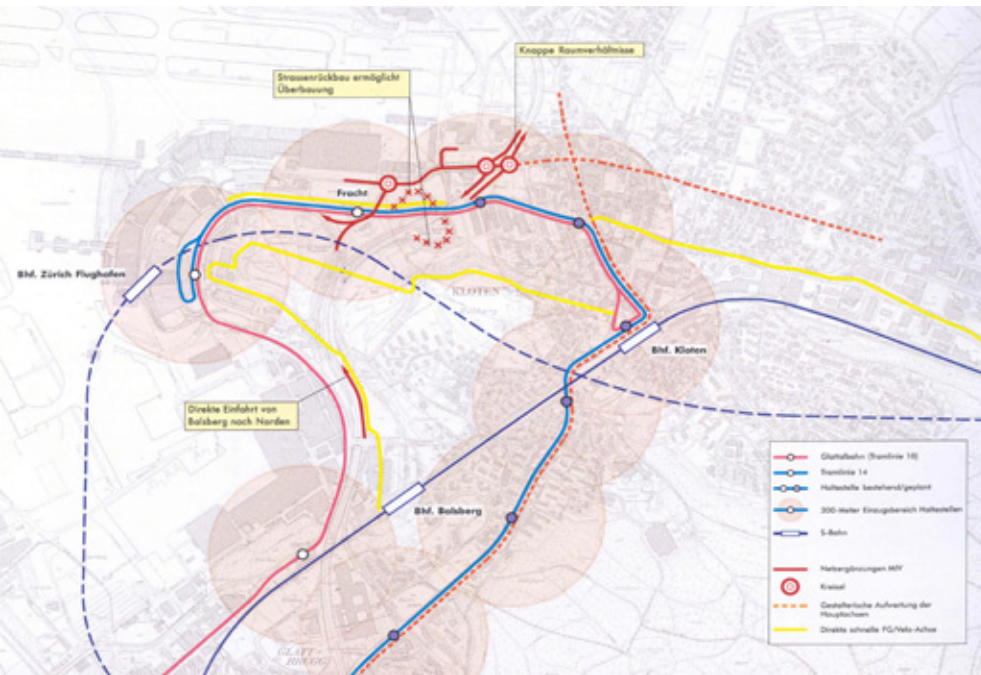

public transport



phasing

section over airport and green heart

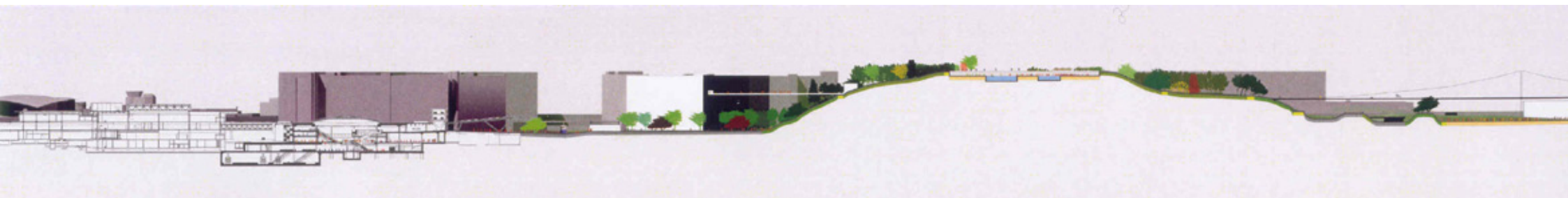

in Europe such coexistence is possible, then is it here - where the airport city on a highly concentrated area shared with the town center can exist, where city and airport are on the same neighborhood and with excellent connection possibility, and where the overlaps on space

requirement can be used for common high-quality developments. This fruitful coexistence is made possible, deepened and consolidated by three strategic components: A three-polar shared urban airport city. The Airport City Zürich Kloten consists of three complementary poles: around

the terminals and the train station of the airport, the one at the station of Kloten and next to its town centre and the one around the multimodal station at Balsberg. On these polarities a mix of functions, local and international ones, would take place. The coexistence and good placement

regarding the urban tissue of several activities like offices, culture, housing, shopping, training and health- research will fulfill the space around the main transportation nodes and the urban centrality. A qualified open space on the middle of the 3 poles. The 3 polar Airport City will have



Airport City Zürich Kloten Tri-polar development around a green heart

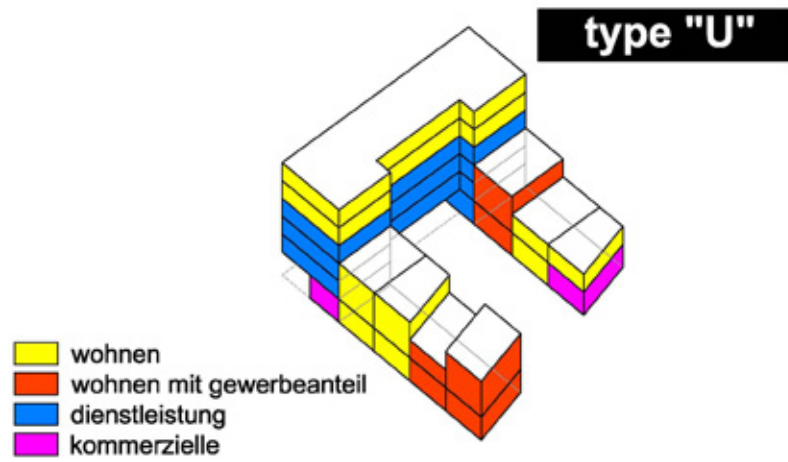
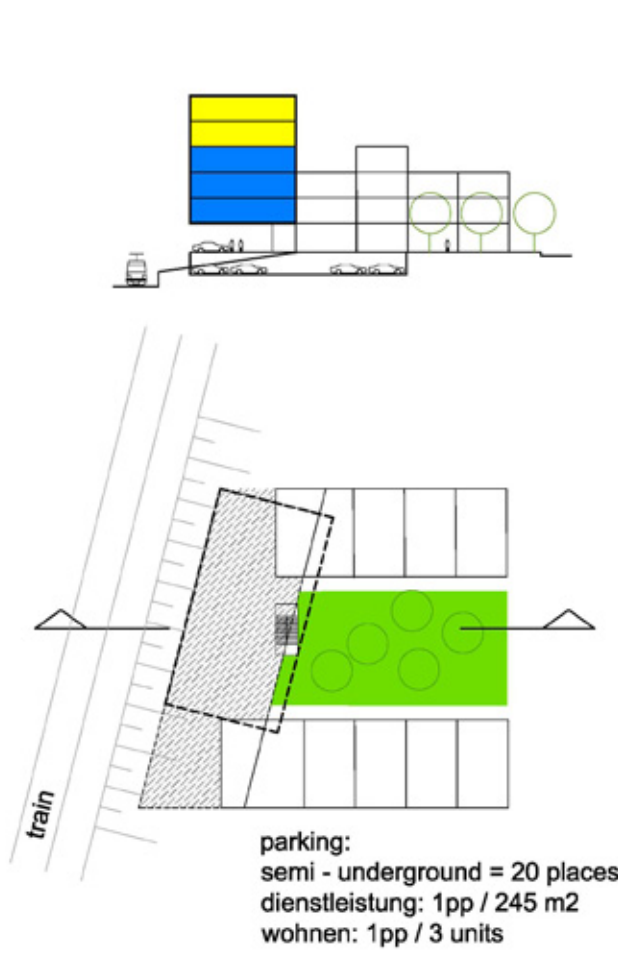

catalogue of building typologies

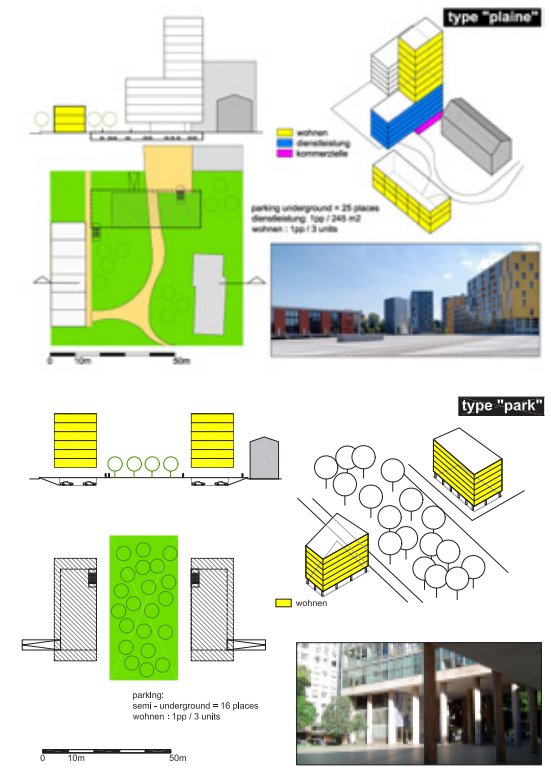

a linking element which gives unity, linkages and quality to the overall strategy. A green heart, which can be more than a green space also an active zone for activities, linked to the city of Kloten, to the working environments of Balsberg and to the Airport City. It will act also

like adding a branding image to all the Airport City environment. a simple and clear development structure in the 3 poles. The spatial linkages of the 3 poles are made by an integral network of public transportation and slow traffic lines. Public spaces next to the main hubs will fill with

urbanity the core of the poles, and typological variety will make sure coexistence of uses and adaption to a dynamic development reality.